

INSTRUCTIONS FOR USE

- Before use, make sure hair is clean and tangle-free.
- Fill the tank to your desired level with water. Our product will have $\pm 10^{\circ}\text{C}/50^{\circ}\text{F}$ temperature difference.
- Plug in the unit, press the ON/OFF switch until the LED light turns on.
- When the flashing light stops to reach the desired temperature, choose steam setting: OFF/LOW/HIGH. Run the straightener through the entire length of hair, without stopping.
- Repeat only twice per section to prevent hair damage.

STRAIGHTENING

STEP 1: Prep your hair. Make sure your hair is clean & tangle-free.

STEP 2: Depending on your hair type and length - this information below is aimed at medium hair types and shoulder length hair. Take a 2" wide x 1/4" thick section of hair. Move the Styler over the sectioned hair starting at the roots about 1/4" away from the scalp, run the Styler slowly through to the ends of the hair with light pressure.

STEP 3: Repeat this process, section by section until your hair is completely straightened, soft and smooth.

CURLING

The steam hair straightener with its rounded edge plates enables you to also create curls, waves, and other hair styles.

STEP 1: Prep your hair and make sure your hair is clean & tangle-free.

STEP 2: Take a small section of hair, and insert it into your Styler. Your sections can vary in size for a more natural, beautifully imperfect look. You may also decide where you would like your curl to start and can place your Styler accordingly.

STEP 3: Twist your wrist, (the one holding the Styler), about a half-turn, then pull, then twist again, then pull. Keep repeating this until you reach the end of your hair. For a more beach feel, keep the very ends of your hair out of the Styler.

STEP 4 (ALTERNATIVE): Twist and pull just as Step 3 indicated, but for a tighter curl, twist the mid-shaft to ends around the entire iron mimicking what you would do with a curling iron.

STEP 5: Continue with Step 3 - either version, throughout your entire head of hair. For more variation you can switch the direction of your curls, vary the section size, and begin the curls at different parts of your hair. You may want to change the direction of your curls near you face, (depending on the side), if you wish to have them sweep away from your face. Again, this is a personal preference that is entirely up to you.

STEP 6: Comb your fingers through to break up the curls. Take your hands and shake your hair out. Keep in mind that using the Styler to curl is a technique that takes some practice, so be patient with yourself. This technique is meant to be sexy, creative, and flirty, so just have fun with it! Now, it's your turn to try it out.

SUGGESTED STYLER TEMPERATURE SETTING	HAIR TYPE
Low $150^{\circ}\text{C} = 300^{\circ}\text{F}$	Fragile, very fine textured hair
Medium $190^{\circ}\text{C} = 375^{\circ}\text{F}$	Normal, normal textured hair
High $230^{\circ}\text{C} = 450^{\circ}\text{F}$	Thick resistance, coarse textured hair

CLEANING AND MAINTENANCE

Ensure the unit is unplugged and cool. To maintain the effectiveness of your product wipe clean after use with a damp cloth. Do not use an abrasive cleaning fluid to clean, as damage will occur.

SERVICE AND WARRANTY

This product has been checked and is free of defects. If the product should become defective within the warranty period, we will repair any such defect or elect to replace the product or any part of it without change provided there is proof of purchase. This does not mean an extension of the warranty period.

If you find the tank has a little water in it, that's normal, because our product is 100% tested with water as part of our quality control procedure.



Distributed by:

Thane Canada Inc.
Mississauga ON L4W 5M6, Canada
www.thane.ca

Thane USA, Inc.
Canton, OH 44718, U.S.A.
www.thane.com

Thane Direct UK Limited
3 Acorn Business Centre,
Northarbour Road, Portsmouth, PO6 3TH
www.thane.tv

© 2024 Thane IP Limited.
"Thane", "H2O", "Steam Styler" and related logos and variations are trademarks or registered trademarks, in Canada and/or other countries, of Thane IP Limited and/or its affiliated companies.

MADE IN CHINA

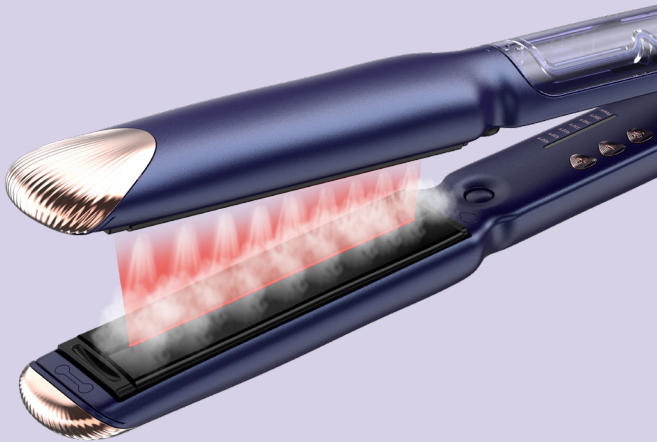

USER MANUAL

KR-088H & KR-088D



Visit QR Code for Full Manual





IMPORTANT SAFETY INSTRUCTIONS

This appliance is designed for household use only. When using electrical appliances, especially in the presence of children, basic safety precautions should always be followed to reduce the risk of fire, electric shock, and injury, including the following:



WARNINGS

- To reduce the risk of fire, electric shock, or injury, read all instructions carefully.
-  Do not use near bathtubs, showers, sinks, or other water sources. If the appliance falls into water, unplug it immediately. Do not reach into the water.
- Do not immerse in water or other liquids.
- The appliance must be plugged directly into a proper electrical outlet.
- This appliance is designed for dual voltage (100V - 240V).
- Before use, ensure that your electrical outlet voltage falls within range.
- Using the appliance with an incompatible voltage may result in damage or safety hazards.
- If used in a bathroom, it must be connected to a GFCI-protected electrical outlet.
- Do not use an extension cord.
- Do not wrap the cord around the unit. Check cord regularly for any sign of damage.
- Do not use it with a damaged cord or plug. If the cord or plug is damaged, it must be replaced by the manufacturer or a qualified service person.
- Unplug when not in use. Always unplug before cleaning.
-  Burn Hazard. Hot surfaces. Do not touch. The plates get extremely hot during use. Avoid direct contact with skin.
-  Danger of Scalding. This device emits high-temperature steam that can cause burns.
- Do not touch the steam outlet while the device is in use.
- Keep hands, face, and skin away from the steam release area.
- Allow the appliance to cool completely before handling or storing.
- Never leave the appliance unattended while plugged in or switched on.
- This appliance is not intended for use by persons (including children) with reduced physical, sensory or mental capacities, or lack of experience or knowledge, unless they are supervised or have been given instructions beforehand concerning the use of the appliance by a person responsible for their safety. Children should be supervised to ensure that they do not play with the appliance.

**WARNING – DOUBLE INSULATED APPLIANCE
SAVE THESE INSTRUCTIONS**

- Do not place it on flammable surfaces (e.g., furniture, bedding, carpets, towels). Always use a heat-resistant mat.
- If the appliance overheats or malfunctions, discontinue use immediately and contact the manufacturer.
- Do not use any other liquid other than water and hair products approved by the manufacturer or pre approved Steam Styler accessories in your H2O Steam Styler to avoid damage to the unit.
- Do not dispose of this appliance with household waste. Follow local electronic waste disposal guidelines.

STEAM RELEASE SETTINGS

There are 3 settings on the Steam Release Dial. Please see the under side of the styler. See diagram below.

The settings are:

1. **OFF - No Steam**
2. **Low Steam**
3. **High Steam**

To release the Steam turn the button clockwise to the designated steam position.
Caution: The steam activates over 100°C/212°F

As you start to use the Styler you will notice steam start to come through the steam vents.

FEATURES AND BENEFITS

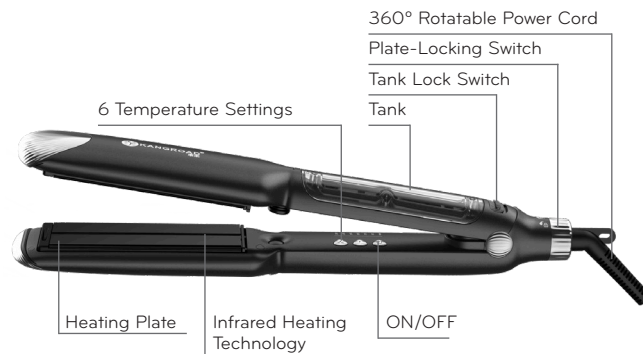

Infrared Heating Technology

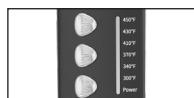

Flashing LED Light Indicator



18 Conditioning Steam Vents



OFF/LOW/HIGH Steam Setting

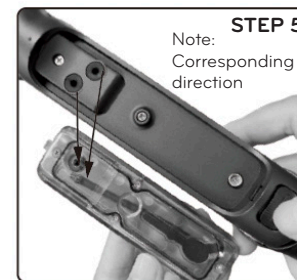

Tip: Please switch on the steam setting after the temperature reaches the set temperature.